

# IPCSL-RWB

Large IP Display

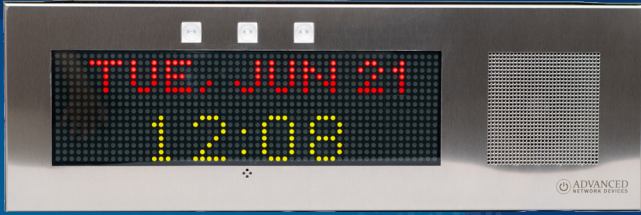

## Overview

Notify large audiences in auditoriums, cafeterias, or multi-purposes spaces with the PoE Large IP Display. Display alerts, countdown timers, and announcements on the large 17" x 5" display using multi-colored text, LED flashers, and 8 inch speaker to be seen and heard throughout the large space.

The IPCSL-RWB easily integrates with VoIP phone systems, approved 3rd party software, and includes ClockWise Campus software with purchase.

## Description

2:46 PM  
42

### DISPLAY

Multi-color LED scrolling text and pixel graphics. 1-line or 2-line display.



### MICROPHONE

Hands-free two-way intercom.



### FLASHER

One red, one white, one blue LED flasher. Individually controlled.



### AUDIO

8" high-efficiency speaker audio coverage up to 600ft<sup>2</sup>.



### PERIPHERAL INTEGRATION

Connect a strobe, motion sensor, electronic lock, call button, etc.



### SOFTWARE

ClockWise Campus software included. Compatible with approved third-party software.



### SIP INTEGRATION

SIP-enabled. Easily interfaces with VoIP / SIP phone systems.



### LIGHT SENSOR

Auto-dimming display.

## Solutions

- Paging
- Intercom
- Bell scheduling
- Code alerts
- Emergency notification
- Access control
- Security monitoring
- Music streaming

## Additional Features

- Built-in web server
- Full multicast and broadcast support
- Requires Cat5 or Cat6 cable
- Back enclosure is included
- Atomic time

## Compatible Peripherals

- **Strobe Kit**
- AND-STROBE-KIT-1
- **Call Button Kit with Mic**
- BTN-KIT-MIC-ND

## Dimensions

(Dimensions are subject to change)

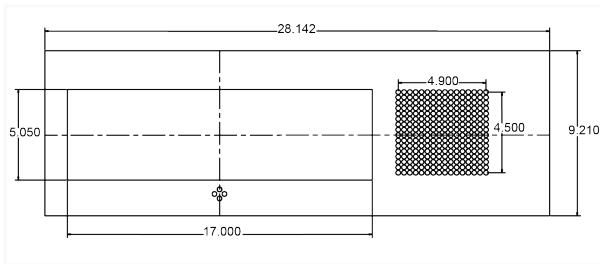

Front

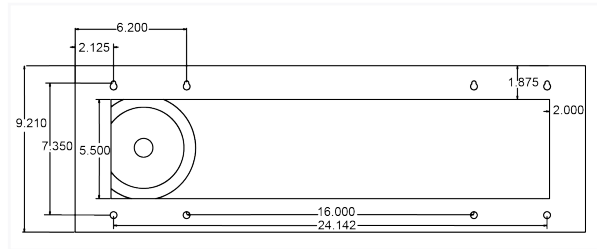

Back

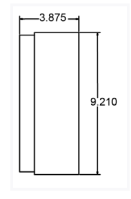

Side

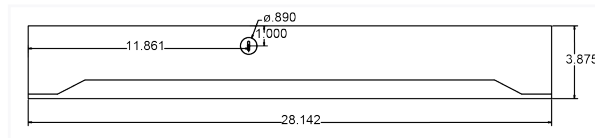

Top

## Specifications

Due to continual product development, specifications are subject to change without notice.

Power Input	PoE (IEEE802.3af) 15.4 W or PoE+ (IEEE802.3at) 30.0 W
Ethernet I/F	10/100 Mbps
Speaker Size	8"
Audio Power	8 W / 16 W
Frequency Response	60 Hz - 17 kHz
Audio Payload Types	G711, A-law and $\mu$ -law
Average Sensitivity	95dB, 1W / 1 M
Supported Protocols	SIP, IPv4, IPv6, 802.1X, HTTP, SLP, TFTP, NTP, SNMPV1 & SNMPV2c, DHCP, IGMP, ICMP, TCP/IP, LLDP-MED, UDP, MDNS & MDNS-SD
General Purpose Interface	2 GPI: 1 via RJ-11, 1 via Cable Harness 1 GPO 17.5 VDC
Operating Temperature	14° TO 122° F (-10° TO 50° C)
Dimensions	28.14" W x 9.2" H x 3.88" D
Weight	15 lbs (6.8 kg)
Warranty	2 Year Limited

